

The PRIDE of North Plainfield



Published by Renna Media On-line at RennaMedia.com

ISSUE 68 • FEBRUARY 2018



Sudden Service with a Smile. 24/7 since 1985.

EXPERT BATHROOM & KITCHEN REMODELING

**Professional Reliable Service
All Makes & Models**

800.760.7199

908.226.1616

210 New Market Avenue.
South Plainfield, NJ 07080
www.rupcoepumbing.com



Be Proud To Stop A Trane!

Tom Ruperto Plumbing Lic # 7244
Jim Coyle Plumbing Lic # 7189

**\$50 OFF
ANY REPAIR**

Mention this offer; no need to cut!
1 coupon per customer.
Not valid with any other offers.

INTERACT CLUB SUPPORTS SCHOLARSHIP PROGRAM

Submitted by Michael Townley

The North Plainfield High School Interact Club sent 15 members to a recent Rutgers University basketball game to staff two concession stands and raise money for scholarships.

Along with the Rotary Club of Plainfield-North Plainfield, the Interact Club members attend eight to 10 basketball games a year with four to six Rotarians, all working concessions for men's and women's games.

The Interactors prepare hot dogs, hamburgers, cheeseburgers, hot pretzels, and hot popcorn. They make fountain sodas to order, serve up candy and chips, hot chocolate, and coffee for the hungry fans. Their reward is the opportunity to work together, develop skills in dealing with customers, and sharing the fun of a social evening with others.

"We have been working concessions at Rutgers for over seventeen years," said Michael Townley, a member of the Rotary club who chairs the event. "For almost half that time, the Interact Club has supported our project with their hard



(above) Interact Club members pose with their adviser, Alexandra Pereira (third from right, back row) before the start of a recent Rutgers University women's basketball game. The club staffs the concession stand in the background to help raise money for scholarships.

work and dedicated service."

Interact clubs are the high school equivalent of Rotary clubs, serving others through various projects and programs. At North Plainfield High School, they are led by Alexandra Pereira, a Spanish language teacher and the club's adviser.

"Alex is a great club adviser," said Townley. "She guides the club through their own activities and service projects, such as sponsoring blood drives, and really allows them to develop their leadership skills. Alex also identifies the 'best of the best' for recognition as 'Students of the Month' throughout the school year."

From the slowest nights at the concession stand to the busiest, the Interactors take their jobs seriously. "I love working with the kids at the Rutgers games," said Roberta Smith, Rotary club president. "They are so enthusiastic and conscientious about their work, it's fun to be there with them. The scholarships that we award at North Plainfield High School only go to members of Interact. This is our way of thanking them for their hard work and dedication to our club and the community."

The Plainfield-North Plainfield Rotary Club is open to membership by business and community leaders in the Plainfield's and in the surrounding towns. Club members meet Wednesday's for a luncheon meeting at Giovanna's Restaurant, 1462 South Avenue, Plainfield. Anyone wishing to learn more about Rotary and the many opportunities to volunteer assistance to the Rotary Club should come to a meeting as a guest of the club, or contact the club through PNPRotary@gmail.com or call 908-822-1441.



(above) Three members of the Interact Club pose with their adviser, Alexandra Pereira (second from right) in the concession stand at Rutgers University basketball.

PLACE YOUR AD IN THIS SPACE!

Each month 8,300 newspapers are printed and mailed free to every home and business in North Plainfield. We mail 100,000 newspapers monthly in 18 towns.

Call Tina today for more information.

908-418-5586 or email info@rennamedia.com



PRSR STD
U.S. POSTAGE
PAID
PHILA PA 191
PERMIT NO. 7575

ECRWSS

*****ECRWSEDDM*****

POSTAL CUSTOMER

The PRIDE of North Plainfield

The Pride • Page 2 • February 2018

The Pride of North Plainfield is published by Renna Media. 6,500 newspapers are printed monthly and are mailed to every businesses and homes in North Plainfield, NJ using the 07060 zip code and are distributed for free pick-up throughout town.

Although great care has been taken to ensure the information contained within is accurate, Renna Media assumes no liability for errors or omissions.

©2018. Contents of this newspaper cannot be reproduced without written consent from Renna Media.

Renna Media welcomes the comments and concerns of its readers put into writing and sent via phone, fax or email to:

Renna Media, LLC

Publisher: Joe Renna

202 Walnut Ave. Cranford, NJ 07016

Phone: 908-447-1295

Fax: 908-709-9209

Email: joerenna@rennamedia.com

PROMOTE YOUR EVENT

Community service organizations and sports teams are encouraged to submit news of upcoming events or highlights and photos on recent events.

Organizations who are interested in submitting content can email editor@rennamedia.com or call 908-858-4012

ADELE DELEEUEW SCHOLARSHIP

A scholarship fund of \$1 million was established by the late Adele DeLeeuw to assist needy students in the Plainfield area for their pursuit of post-secondary education. The fund is managed by PNC Advisors (PNC), and is administered by the Plainfield Foundation through the Rotary Club of Plainfield-North Plainfield.

Adele DeLeeuw was a well-known author of books for children of all ages, a prominent Plainfield resident for almost her entire life. She was a patron of the arts and literature, and took a special interest in young people.

Adele lived in Plainfield with her parents and her sister, Cateau, who was an artist. Her father was a consulting engineer with an office in New York City.

After their father and then their mother passed away, Adele and Cateau continued to reside in Plainfield. They were members and proud supporters of many literary and arts organizations in the area.

Adele was also a champion for her City of Plainfield. An article in the Courier News from 1979 said that Adele "relishes giving the Queen City, her home since 1914, an oral or written boost."

She had the opportunity to give that support in her freelance writings for the Courier News over an eight-year period. Her opinion pieces were well-received, and were eagerly anticipated by many readers.

Adele died on June 13, 1988. She was pre-deceased by her sister, Cateau. With no

immediate survivors, Adele set aside a portion of her estate for a scholarship program to be administered by the Plainfield Foundation.

Reflecting her own and her family's interests, Adele stipulated in her will that the annual earnings from her scholarship endowment would be awarded to graduating seniors from high schools in Plainfield, North Plainfield, South Plainfield, Edison, Fanwood, Scotch Plains, Watchung, and Warren. She further stipulated that eligible seniors must pursue a course of study in art, poetry, writing, journalism, or engineering; courses of study that reflected her own family's careers and interests.

Eligible students who receive first-year scholarships are encouraged to submit applications for subsequent years and receive additional awards.

To be eligible applicants must attend or be accepted to attend an accredited college or university on an undergraduate or graduate level in one of the eligible areas of study: art, engineering, journalism, poetry, and writing.

Eligible students can download the application form here: www.rotarypnp.org/pdfs/DELEFORM2018-19.pdf



Welcoming Everyone
Celebrating Diversity
Following Jesus

**WATCHUNG AVENUE
PRESBYTERIAN CHURCH**
We are known for our openness,
warmth and congeniality. Come, give us a try!

170 Watchung Avenue North Plainfield, NJ
908-755-2781 www.wapc.net

UnitedHealthcare®
Medicare Solutions

Margot Hamel
Independent Sales Agent

Authorized to Offer
AARP®
Medicare Plans
by UnitedHealthcare

908-625-3700

Helping people live healthier lives.

SALUTE
To Our Veterans

**You Served For Us...Now
It's Your Time to Relax...**

- For Individuals, age 62 plus.
- Income: \$18,000- \$58,600
- Private suite with full bath.
- Dining, maintenance & cleaning included.
- On-Floor Laundry, on-site parking.
- Wi-Fi throughout.
- Handicap Accessible.

CHC
SENIOR HOUSING

PLEASE CALL (908) 526-8130
OR VISIT CHCHOUSING.ORG
FOR MORE INFO.

IT'S TIME FOR NEW DENTURES!

If your dentures ...

- Are loose
- Over 5 years old
- Have been repaired many times

Or ...

- You would like to improve your smile

Then call today for an appointment!

- The doctors at Dentalcare associates will provide all your denture needs.

**Most Insurances Accepted
Interest Free Financing**

908-322-7800
567 Park Ave., Scotch Plains NJ
www.njdentalcare.com/dentures

DENTALCARE ASSOCIATES
COSMETIC, IMPLANT, AND FAMILY DENTISTRY

SAVE \$500
UPPER & LOWER DENTURES*

*Reg. 2050-\$2295 per arch Add'l fees may be incurred. Present this ad. Not valid with other offers. Dr. R. Scalera Jr, Director. Expires 2/28/18 RM

Ask about Implant supported dentures

- 1 HOUR DENTURE REPAIRS
- 3 HOUR LAB RELINES
- LABORATORY ON PREMISES
- All repairs schedule permitting

DORMERS & ADDITIONS • DECKS & PORCHES • MASONRY STEPS & PATIOS



Kitchens



Baths



Basements



Attics



Decks



15% WINTER SAVINGS

With this ad. Up to \$1,500 on any job. Not valid with other offers or on prior purchases. Not to be combined with any other offer. Expires 3-31-18.

Low Monthly Payment Plans

Porches/Steps \$105	Windows \$189	Basements \$295
Bathrooms \$199	Kitchens \$289	Decks/Patios \$139
Roofing \$179		Siding \$259

0% for up to 18 Months

Estimated monthly payments. Rates & payments based on credit approval.

www.MagnoliaHomeRemodeling.com



Licensed & Insured • LO65735 • NJ DCA: 13VHD7755300



**Call Today
for a Free Estimate!
855-624-6655**

**Affordable,
Professional & Reliable**

- ✓ Family Owned & Operated
- ✓ 25+ Years Remodeling Experience
- ✓ Angie's List Service Award Winner
- ✓ BBB A+ Rated
- ✓ HomeAdvisor Screened & Approved
- ✓ GAF Certified Roofing Installer
- ✓ 100% Financing Available
- ✓ 0% Interest Programs
- ✓ Outstanding Workmanship
- ✓ CertainTeed Building Solutions Specialist

Family Owned & Operated



Siding



Roofing



Windows & Doors



Masonry



Porches

SIDING & ROOFING • WINDOWS & DOORS • KITCHENS & BATHS • BASEMENTS & ATTICS

FOLK MUSICIAN TRACY GRAMMER COMES TO WATCHUNG ARTS CENTER

Celebrating the release of her new CD, "Low Tide," Tracy Grammer comes to the Watchung Arts Center for a Sunday afternoon performance on February 11, 2018 at 3 p.m. Tracy will be joined by singer and multi-instrumentalist Jim Henry. The audience will have an opportunity to meet Tracy Grammer at the special dessert reception following the performance.

Tracy Grammer rose to acclaim as half of the "postmodern, mythic American folk" duo, Dave

Carter & Tracy Grammer. From 1998-2001, the duo released three internationally celebrated, folk chart-topping albums featuring Carter's mythopoetic Americana songcraft and in 2002, toured with Joan Baez, both as featured artists and Baez's band members. Called "the new voice of modern folk music," the duo was clearly in its ascendancy when in July 2002, Carter suffered a fatal heart attack while the duo was on tour. He was 49; Grammer, 34.

Determined to honor the duo's journey and bring Carter's songs, and those of other favorite writers, to broader audiences, Grammer has kept to the road, releasing solo albums as well as selections from the Dave Carter & Tracy Grammer archives.

Grammer has become one of folk music's most beloved artists. Renowned for her springwater-clear alto, perfectly intoned violin, and guitar playing that is by turns percussive and delicate, Grammer is also a masterful storyteller with an ease and charisma on stage -- not to mention a riotous sense of humor -- that hardly belie her modest beginnings as Carter's reclusive accompanist. Stories about the duo's first meeting, Carter's quirks and fancies, or Grammer's own misadventures and missteps are woven thoughtfully into the set list to create a uniquely personal evening that connects audiences to performer, to the Carter/Grammer legacy, and most importantly, to one another.

As one fan put it, "With Tracy, it's never just about the music. It's a soul journey."

Tickets are \$20 in advance, \$22 at the door. You may purchase tickets securely through Eventbrite.

For more information, please call 908-753-0190 or e-mail us wacenter@optonline.net.

The Watchung Arts Center, located at 18 Stirling Road in Watchung on the Watchung Circle, is a multi-disciplinary arts facility serving Watchung, the surrounding communities and the Tri-State Area. To obtain more information about upcoming performances, classes and workshops, and monthly art exhibitions, please visit WatchungArts.org or call 908-753-0190.



Red House Records Recording Artist Tracy Grammer

Photograph by Ben Barnhart, © Ben Barnhart

Discover KYBELLA®, the first and only FDA-approved injectable treatment to reduce fat under the chin.



Adra took the "double" out of her chin with KYBELLA®



Consult One of The Top Injectors
in the Central Jersey Area,
Dr. Patricia Barsanti



Join us for our
Kybella Info Event
February 28, 2018

4:30pm - 6:30pm

**Come for your FREE consultation
& also meet Kybella patients!**

**Book your treatments at the event
and take \$600 off the price.**

RSVP TODAY!

Limited Appointments Available.

Call or E-mail to RSVP at:

908-755-8400

info@BellaFinaMediSpa.com

154 Mount Bethel Road, Warren NJ 07059 • www.BellaFinaMediSpa.com



HIBACHI GRILL

supreme buffet

**Serving
LOBSTER or CRAB LEGS
with other Special Items
Every Holiday**

For more information, please call

908-490-1600

Fax: 908-490-1601

www.hibachigrillandbuffetnj.com

BLUE STAR SHOPPING CENTER

10% DISCOUNT
Seniors 60+, Military,
Police, College Students
Hibachi Grill Supreme Buffet (Show ID)



Large Parking Lot to
Accommodate our Customers

1701 U.S. Highway 22 West • Watchung



MONDAY - THURSDAY

Lunch 11am - 3:30pm	Dinner 3:30pm - 10:00pm
Adult\$7.99	Adult\$11.99
Kids 7-10.....\$5.99	Kids 7-10.....\$7.49
Kids 3-6.....\$3.99	Kids 3-6.....\$5.99
2 & Under.....FREE!	2 & Under.....FREE!

FRIDAY - SATURDAY

Lunch 11am - 3:30pm	Dinner 3:30pm - 10:30pm
Adult\$7.99	Adult\$11.99
Kids 7-10.....\$5.99	Kids 7-10.....\$7.49
Kids 3-6.....\$3.99	Kids 3-6.....\$5.99
2 & Under.....FREE!	2 & Under.....FREE!

SUNDAY ALL DAY DINNER

11am - 10pm

Adult.....\$11.99
Kids 7-10\$7.49
Kids 3-6\$5.99
2 & Under.....FREE!

GIFT CERTIFICATES AVAILABLE

SUSHI

Fantastic range of freshly prepared sushi.
Most selection and top quality among all competitors.
It is far from the typical "buffet quality" sushi.
At HIBACHI, you don't sacrifice taste for price.

BUFFET

Elegant, modern, fresh, executed with care and confidence. HIBACHI Grill Supreme Buffet brings together 250+ of fresh-made Asian dishes in eleven buffet bars.

HIBACHI

Choose your favorite ingredients from dozens of seafood, meats and vegetables. Watch our chef preparing them in our special hibachi sauce to create a full-flavored dish.

ASK US ABOUT CATERING YOUR NEXT EVENT!

We have a large party room available for birthday parties, office meetings & weddings.

\$125 OFF
ADULT BUFFET

With purchase of a beverage per person
Watchung • 908-490-1600
Cash Only. Limit 4. Not valid with any other
offers or discounts. Expires 3/10/18.

\$250 OFF
**2 ADULT
BUFFETS**

With purchase of a beverage per person
Watchung • 908-490-1600
Cash Only. Limit 4. Not valid with any other
offers or discounts. Expires 3/10/18.

\$10 OFF
**ANY ONE
PARTY**

Of \$100 or more. Monday - Thursday Only.
Watchung • 908-490-1600
Cash Only. Limit 4. Not valid with any other
offers or discounts. Expires 3/10/18.

\$500 OFF
**4 ADULT
BUFFETS**

With purchase of a beverage per person
Watchung • 908-490-1600
Cash Only. Limit 4. Not valid with any other
offers or discounts. Expires 3/10/18.

CHANGING LIVES IN SOMERSET COUNTY

Imagine living in a country where you cannot communicate with your children's educators, doctors, and/or caretakers due to a language barrier. How would you feel?

According to the 2017 Census, 2.6 million New Jersey residents and 30.2 percent of households in Somerset County speak a language other than English at home. These statistics demonstrate the need for English as a Second Language (ESL) education.

Yuliana Ballestro, a Costa Rica native and Bridgewater resident, is one of those individuals, who primarily speaks Spanish at home.

"I wanted to start to learn English to be able to communicate with my children's teachers and doctors," stated Ballestro, a mother of two.

Ballestro came across an advertisement for ESL instruction from Literacy Volunteers of Somerset County (LVSC) in a local newspaper. The organization paired her with tutor Ann Beth Constad, a retired language therapist.

"My passion has always been language and literacy," stated Constad. "I thought it would be wonderful to give back to the community and put

my skills to use with adults."

The pair meets for 90 minutes a week at Somerset County Library System New Jersey (SCLSNJ)'s Bridgewater Library branch, located at 1 Vogt Drive in Bridgewater, New Jersey. The Library provides an ideal location for tutoring sessions by offering a flexible and convenient space with multiple resources.

Ballestro, who started learning English in November, has made great strides in her communication skills. She is able to pick things up quickly and carry short conversations in English with the help of Constad, LVSC, and the Library's resources. Like many ESL students, Ballestro has a goal in mind. She desires to open a car repair business with her husband where she will work as the secretary – answering phones and helping customers.

"As much as a student learns, the tutor learns more. It's a wonderful feeling knowing that I am helping someone meet their goals and dreams," stated Constad.

In the past year, LVSC has provided 307 adults weekly tutoring from 187 volunteer tutors. Tutors

have provided more than 3600 hours of free tutoring through English conversation groups, one-on-one tutoring sessions, and citizenship classes.

"LVSC offers a unique opportunity for volunteers to truly make a difference in our community," stated Susan Engelstein, LVSC's program manager. "Through weekly meetings, our tutors work with their students on real-life, achievable goals, whether it is speaking to a child's teacher or to a doctor, obtaining a driver's license, or practicing for a job interview. Tutors provide encouragement, friendship and literacy instruction, forging lasting bonds with their students."

Practice speaking English in a friendly setting. Basic English skills required. SCLSNJ's Warren Twp. Library branch, located at 42 Mountain Boulevard, Warren Township, New Jersey, Mondays, 10 to 11:30 a.m.

SCLSNJ's North Plainfield Memorial Library branch, located at 6 Rockview Avenue, North Plainfield, New Jersey, Mondays, 7 to 8:30 p.m.

For more information: SCLSNJ.org



American Boys Prep
Liberty, Fraternity, Opportunity



Learning

Union County's #1 Homeschool Alternative

Features: * Flexible Hours * Homework Optional
* No Exams * Self-Paced * Ample Breaks & Recess

Ideal for: • Gifted & Talented • ADHD • ESL
• Actors • Models • Artists • Elite Athletes

www.ABP-Academy.org 908.516.4231



GO FAR
PREPARING YOUNG MINDS
TO CHANGE THE WORLD.
A co-educational day school for PreK-Grade 8



Steven
Grade 5

Far Hills, NJ | fhcds.org
Summer Camp Registration Now Open!

**UGLY HOMES WANTED
FOR TELEVISION PROGRAM
IN THIS AREA**

We need 30 Ugly Homes with Ugly Kitchens, Bathrooms, Siding, Window, etc., Inside or Outside that need fixing or Remodeling. We will Repair and Remodel them and shoot video for training film and future TV show on Home Remodeling Work.

Must Sign Release, for purpose of filming job! This must be a complete remodeling job, not just patch up work. This remodeling is to be specially priced out of work, with compensation back to the homeowner for signed release.

CALL 1-800-281-1582
Ask for TV Project Department,
for job evaluation and estimate
of cost and compensations!

Serious Inquiries Please!

LearningRx
one-on-one brain training

"Join us for a presentation on reading difficulties
and why most programs fail to help."

Friday, February 16th from 12 to 1 pm.

RSVP: 908-222-7246
or warren.nj@learningrx.net

Downsize Your Space Upsize Your Lifestyle



YOUR NEW BEGINNING! WARREN INDEPENDENT LIVING!

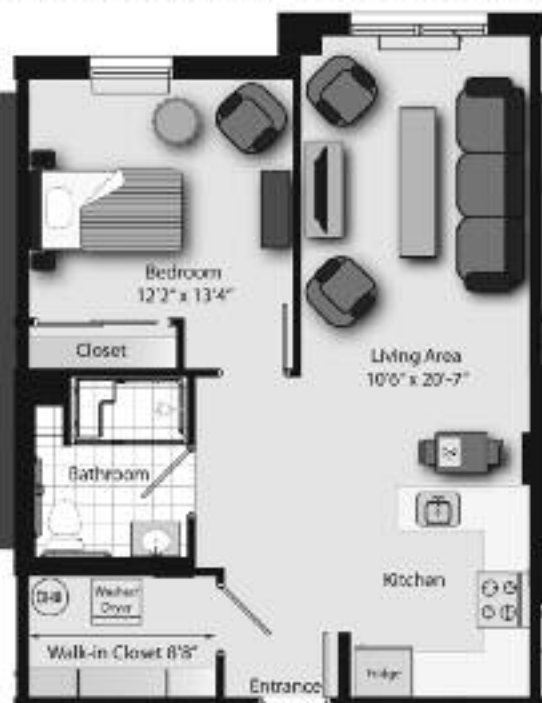

- Brand new, spacious 1 & 2 bedroom apts
- Bistro and Club Room with library, movies, games, events, entertainers
- Exercise room and weekly exercise classes
- Daily Continental Breakfast and Cocktail Hour
- On-site doctors appointments
- Intercom system; Underground parking;

NO BUY-IN REQUIRED! MONTH TO MONTH RENTALS!

"I love the hassle-free living.
I finally have time to enjoy life."
-Dick B, resident



"The key for me was no buy-in
required."
-Martha B, resident



THE CHELSEA
AT WARREN

INDEPENDENT LIVING

274 KING GEORGE ROAD | WARREN, NJ 07059
CHELSEASENIORLIVING.COM

Come visit today! Call Linda at 908-903-0911

CITIZENS FOR COMMUNITY RIGHTS

The next meeting of the North Plainfield Citizens for Community Rights (NPCCR) will be held on Thursday, March 1st at 7 p.m. at the North Plainfield Community Center, located at 614 Greenbrook Road, North Plainfield, New Jersey. Admission is free and residents of other municipalities are welcome to attend.

Our guest speaker will be from the State of New Jersey Department of the Treasury Division of Taxation. The subject "New Jersey's Property Tax Relief Programs" will include discussion of the Senior Tax Freeze program.

North Plainfield still has the highest municipal tax rate in Somerset County. NPCCR posts the current police reports and council meetings on our site. You can view them by going to npccr.org.



michael lamela CPA



908-939-8070
Fax: 908-379-8785
www.lamelacpa.com
mike@lamelacpa.com
210 Haven Avenue, Suite 161
Scotch Plains, NJ 07076

Se Habla Español

Income Tax Preparation & Planning • Business Accounting Services • Business Consulting • Quickbooks Consulting

EXPERIENCED HELP WANTED

Fully Insured Free Estimates

Needleman Roofing

Lic. # 13VH06601300

SLATE - TILE - ASPHALT SHINGLES

908-389-0200

HOME MOVIES TRANSFERRED

to digital files & DVD

- Video Tape Transfers
- DVD & Flash Drive Duplication
- Audio Cassette to CD
- Reel to Reel Audio to CD
- LP to CD
- High Speed Photo & Slide Scanning
- Foreign Conversions

Video Production & Editing
Training • Sales • Documentary

VIDEO DATA SERVICES®

locally owned since 1984

www.vdsnj.com
facebook.com/vdsnj
email: ira@vdsnj.com
908-964-4004
406 Chestnut St. • Union, NJ 07083

LUNCH WITH A LIBRARIAN

Last month Somerset County Library System of New Jersey (SCLSNJ)'s North Plainfield Memorial Library branch patrons attended the kickoff event to introduce 1000 Books Before Kindergarten, part of the Library's new SOARING (Supportive Opportunities for Achieving Reading Skills in the Next Generation) initiative. The early literacy resource is designed to help parents navigate early childhood programming and resources. Patrons brought their lunch and enjoyed stories and songs with Youth Services Librarian, Amy Behr. All participants received a free book.

For more information about SCLSNJ's SOARING initiative visit: sclsnj.org/sclsnj-soaring/

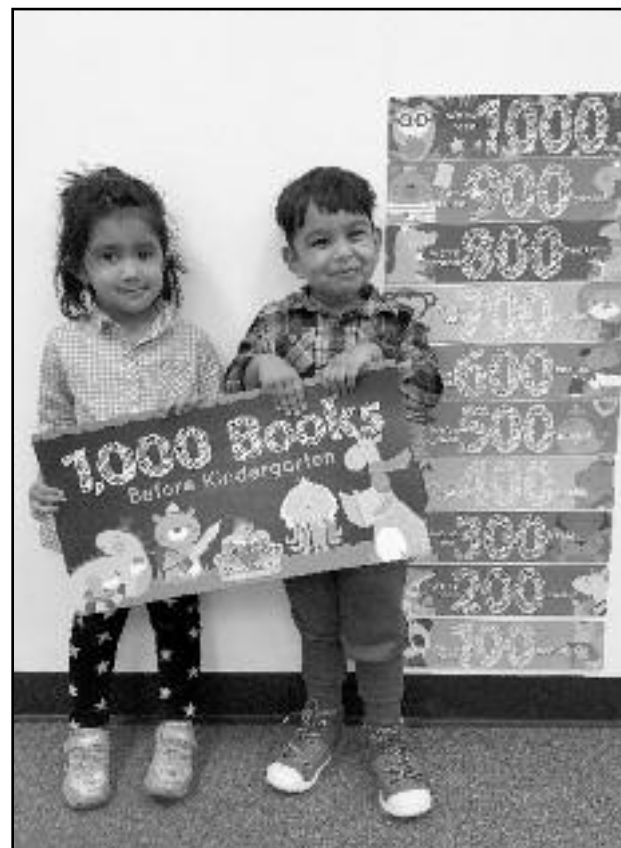

(right, l-r) Subeeksha Jay, 2, and Nixon Drozario, 3, both of North Plainfield.



BOY SCOUTS OF AMERICA®
PATRIOTS' PATH COUNCIL

2018



Sponsored by



5th Annual

Munsee

District

Boy Scout Chess Tournament

Open to all registered Boy Scouts/Venturers/Explorers.
Non-scouts welcomed!

Saturday, February 24, 2018
10:00 am to 2:00 pm
Sign-in/setup starts at 9:00 am

Cranford Community Center
220 Walnut Avenue, Cranford, NJ • 908.709.7283

Registration is \$12 • Note: this is a non-rated tournament.
Non-scouts (under 18 only) can register by calling Joe Renna at 908-447-1295.
Scouts can use Patriots' Path Council Munsee District Double Knot link to register on-line at ppbsa.doubleknot.com/event/2300308
Scouts can email Will Adams at Will.adams@scouting.org for more info.

Trophies awarded to 1st, 2nd and 3rd place finishers.
Lunch will be provided for all players and fans.
This tournament meets the 6a requirement for earning a Chess merit badge.

NORTH PLAINFIELD LIBRARY

The Pride • Page 9 • February 2018

SCLSNJ'S NORTH PLAINFIELD MEMORIAL LIBRARY BRANCH

6 Rockview Avenue, North Plainfield, NJ 07060 • 908-755-7909 • SCLSNJ.org

All programs listed are free. Registration is required unless otherwise indicated and programs are subject to change. Note: SCLSNJ's North Plainfield Memorial Library will be closed on February 19.

ALL AGE PROGRAMS

Happy Birthday Mo Willems

February 3, 10 a.m. to 4 p.m.

Unwrap a Valentine: February 12, 10 a.m. to 8 p.m.

Drop-in Craft: February 14, 10 a.m. to 8 p.m.

CHILDREN, TWEEN, AND TEEN PROGRAMS

Storytime

February 8, 15; 10 to 11 a.m.
(ages 6 months to 3 years)

Harry Potter Book Night

February 6:30 to 8 p.m.
(ages 8 to 12)

Standing Tall in Our Truth

February 6, 13, 20, 27; 3:30 to 5 p.m.
(grades 6 to 9)

Storytime Rhyme and Play

February 7, 14; 10 to 11 a.m.
(ages 2 to 4)

Choose Your Own Adventure

February 7, 14, 21, 28; 3:30 to 5 p.m.
(grades 6 to 12)

African Mask Making

February 8, 3:30 to 4:45 p.m.
(grades K to 5)

Miss Jen's Lab Heart to Heart

February 22, 3:30 to 4:30 p.m.
(ages 5 to 9)

Holiday Celebrations Around the World

February 16, 3:30 to 4:30 p.m.
(ages 5-9)

ADULT PROGRAMS

US Citizenship Course

February 22; 6 to 8 p.m.

English Language Learning

February 5, 12, 26; 9:45 a.m. to 12:15 p.m.

English Language Learning

February 5, 12, 26; 6:15 to 8:45 p.m.

English Conversation Group

February 5, 12, 26; 7 to 8:30 p.m.

English Language Learning

February 6, 9:45 a.m. to 12:15 p.m.

New Year, New You Through Meditation

February 6, 7 to 8 p.m.

English Language Learning

February 7, 14, 21, 28; 9:45 a.m. to 12:15 p.m.

English Language Learning

February 7, 14, 21, 28; 6:15 to 8:45 p.m.

Afternoon Book Discussion

February 8, 1 to 2 p.m.

Morning Knit & Crochet

February 13, 27; 10 a.m. to noon

Healthy Avenues Van:

Blood Pressure and Glucose Screening

February 13, 1 to 3 p.m.

Evening Book Discussion

February 15, 7:15 to 8:30 p.m.

The Roots of Resistance

February 20, 7 to 8 p.m.

Vegan Cooking

February 22, 6:30 to 8:30 p.m.

La Strada Wishes you Buon Appetito!

Ristorante and Pizza **\$2.00 OFF ANY LARGE PIZZA**

Eat-in / Takeout Menu / We Deliver

Bringing you the very best Italian dishes. It is our pleasure to serve you. Feel free to bring your own beer or wine. Call Ahead for Fast Pickup (We accept our competitor's coupons!)

393 Somerset St. (Somerset Square) North Plainfield, NJ **(908) 561-7676** Fax (908) 561-7678

佳好川菜 **HOT & SPICY ASIAN FOOD**

Authentic Sishuan Cuisine

Beef • Lamb • Duck Poultry • Seafood

Dry Wok • Soups • Noodle Fresh Hot Pepper Dishes

Peking Roast Duck

PARTY ROOMS AVAILABLE For up to 50 people.

BUFFET/CATERING Starting at \$25/person On & Off premise **FREE KARAOKE!** With party reservation.

OPEN 7 DAYS A WEEK: Mon-Thu: 11am-10pm / Fri-Sun: 11am-10:30pm

732-752-2100 • www.588xl.com

19 Route 22 E • Greenbrook, NJ (Corner of Rock Avenue)

GRAND OPENING

FIG TREE MARKET

1220 South Ave., Plainfield NJ 07062
908-755-2000

- Fruits and Vegetables
- Fresh Meats
- Boars Head Delicatessen
- Fresh Seafood
- Floral Arrangements
- Dairy and Grocery

HOURS:
8:00am - 8:00pm Mon to Sun

Accept: **VISA** **MasterCard** **AMERICAN EXPRESS** **DISCOVER** **EBT**

FREE DOZEN EXTRA LARGE EGGS WITH ANY PURCHASE
Must present coupon. 2/1/2018 - 2/28/2018

“A farmers market and so much more”

CALL US ABOUT OUR FULL COLOR PRINTING SERVICES AND INSERTS. JOE 908-447-1295



FULL COLOR PRINTING AND INSERTS *DIRECT MAIL TO EVERY HOME AND BUSINESS* **MENUS - PRINTING - \$50 per thousand**

Rate is for quantities of 25,000 or more. For quantities less than 25,000 cost is \$68 per thousand.

11"x17" / Full color / 2 sided / 60lb gloss coated stock / Includes folding (quarter fold or tri-fold, with or without coupons tab)

FLYERS - \$35 per thousand

8.5" x 11" / Full color / 2 sided / 60lb gloss coated stock / Tri-fold add \$10 per thousand

POST CARDS - \$45 per thousand

8.5" x 5" / Full color / 2 sided / 9 point coated stock

Minimum printing quantity is 10,000. Other sizes and stocks can be quoted.

INSERTING:

COST PER THOUSAND INSERTS

Up to 15,000	\$60
15,000 to 30,000	\$55
30,000 to 45,000	\$50
45,000 to 60,000	\$45
60,000 to 75,000	\$40
75,000 to 90,000	\$35
Over 90,000 inserts	\$30

ARTWORK AVAILABLE

FLYERS • BROCHURES • MENUS

STOCK DESIGN AND PRODUCTION

\$300 TO \$600 based on complexity

Large library of stock layouts and images to choose from.

Custom art and photography available.

DIRECT MAIL SERVICE

ANY TOWN IN NEW JERSEY

Call for quote on Art / Printing / Mail Prep / Postage

CUSTOMER SUPPLIED INSERTS: Minimum cost \$400.

Insert size must be smaller than 11" x 7 1/2". Must be void of indicia and mailing label or an additional charge will apply.

JOIN THE HYPERLOCAL ONLINE NETWORK ON rennamedia.com AND SOCIAL MEDIA

**Ask Us About Our
Targeted Advertising and Marketing Opportunities**
Feature your business through • Video • Photo Albums • Press Releases
Websites • YouTube • Facebook • Eblast Newsletter

Joe Renna 908-447-1295 • joerenna@rennamedia.com

Published by Renna Media • 202 Walnut Avenue • Cranford, NJ 07016

RENNA MEDIA
NEWSPAPER RATE SHEET
WE MAIL
125,000
NEWSPAPERS
MONTHLY!

Tina Renna 908-418-5586
tinarennamedia.com

Joe Renna 908-447-1295
joerennamedia.com

202 Walnut Avenue
Cranford, NJ 07016
info@rennamedia.com

Advertise
in 1 or all
21 towns

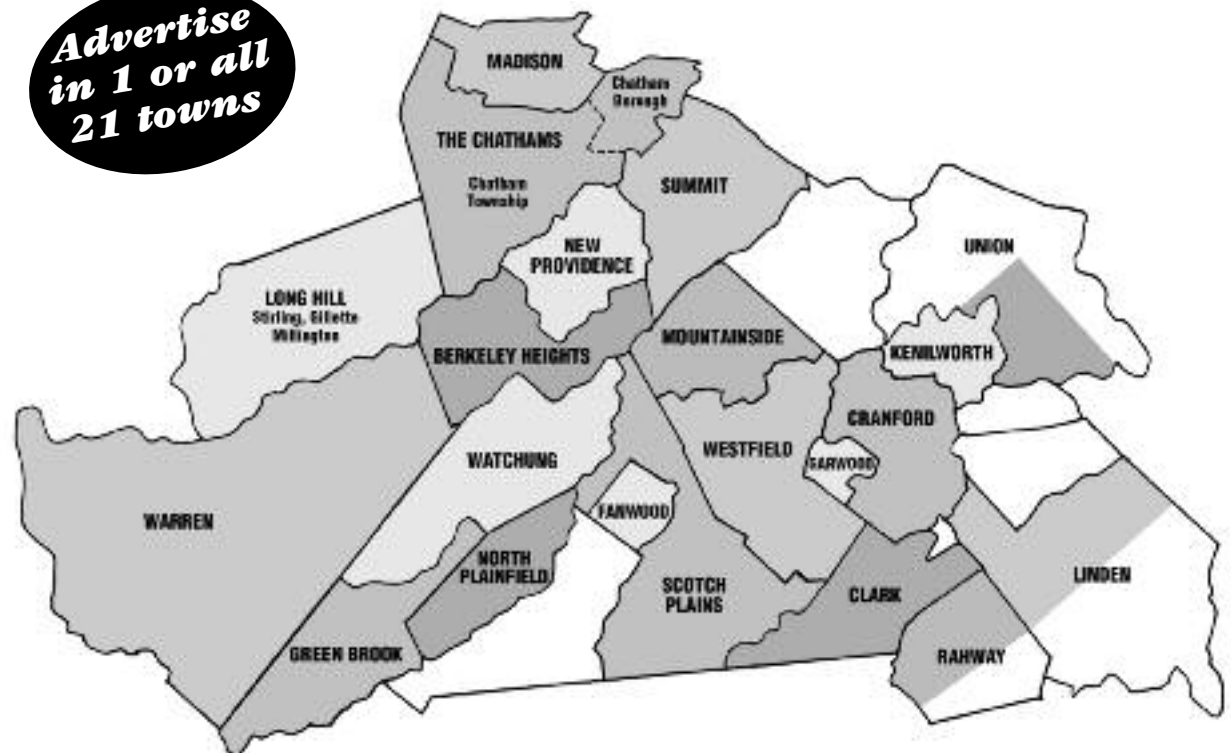

Qty: 4,800
Mailed to every
home and business.
Zip: 07922



Qty: 7,400
Mailed to every
home and business.
Zip: 07928



Qty: 6,700
Mailed to every
home and business.
Zip: 07066



Qty: 9,800
Mailed to every
home and business.
Zip: 07016



Qty: 3,000
Mailed to every
home and business.
Zip: 07023



Qty: 2,200
Mailed to every
home and business.
Zip: 07027



Qty: 3,000
Mailed to every
home and business.
Zip: 08812



Qty: 3,600
Mailed to every
home and business.
Zip: 07033



Qty: 12,500
11,800 mailed to
homes and businesses.
Zip: 07036



Qty: 3,600
Mailed to every home
and business in Gillette,
Millington and Stirling.
**Zips: 07933,
07946, 07980**



Qty: 6,300
Mailed to every
home and business.
Zip: 07940



Qty: 2,800
Mailed to every
home and business.
Zip: 07092



Qty: 4,800
Mailed to every
home and business.
Zip: 07974



Qty: 8,300
Mailed to every
home and business.
**Zips: 07060,
07062, 07063**



Qty: 6,000
5,600 mailed to
homes and businesses.
Zip: 07065



Qty: 9,600
Mailed to every
home and business.
Zip: 07076



Qty: 9,600
Mailed to every
home and business.
Zip: 07901



Qty: 5,500
5,000 mailed to
homes and businesses.
Zip: 07083



Qty: 6,200
Mailed to every
home and business.
Zip: 07059



Qty: 2,800
Mailed to every
home and business.
Zip: 07069



Qty: 11,800
Mailed to every
home and business.
Zip: 07090

NEWSPAPER AD RATES

Rates are per month. Artwork included in price.
Newspapers are black on white.

Units		Size	RATE FOR ANY 1 NEWSPAPER	RATE FOR ANY 3 NEWSPAPERS	RATE FOR ANY 6 NEWSPAPERS	RATE FOR ANY 9 NEWSPAPERS	RATE FOR ANY 12 NEWSPAPERS	RATE FOR ANY 15 NEWSPAPERS	RATE FOR ANY 18 NEWSPAPERS	RATE FOR ALL 21 NEWSPAPERS
1	Unit (Business card)	3.25" x 2"	\$60	\$150	\$250	\$350	\$400	\$450	\$500	\$550
2	Units	6.5" x 2" or 3.25" x 4"	\$100	\$250	\$400	\$500	\$600	\$700	\$800	\$900
4	Units	3.25" x 8" or 6.5" x 4"	\$180	\$450	\$700	\$900	\$1100	\$1300	\$1500	\$1700
6	Units	6.5" x 6.25" or 10" x 4"	\$240	\$600	\$900	\$1200	\$1400	\$1600	\$1800	\$2000
9	HALF PAGE	6.5" x 9" or 10" x 7"	\$320	\$800	\$1000	\$1300	\$1600	\$1900	\$2200	\$2400
12	Units	10" x 8"	\$360	\$900	\$1200	\$1500	\$1800	\$2100	\$2400	\$2700
18	FULL PAGE	10" x 14"	\$400	\$1000	\$1400	\$1800	\$2200	\$2500	\$2800	\$3000
2	PAGE SPREAD	21" x 14"	\$700							
	BACK PAGE	10" x 4"	\$500							
	FRONT PAGE BANNER	8.25" x 2"	\$320							
	FRONT PAGE BOX	1.5" x 4.5"	\$240							

PREPAY FOR 6 MONTHS AND GET 1 FREE

Make Checks payable to Renna Media, 202 Walnut Avenue, Cranford, NJ 07016

Visit **RennaMedia.com** for online publications.

Photo albums, video and advertising opportunities.

Back cover, front page banner and front box reserved on first come,
first served basis. Current advertiser has right of first refusal.

#LoveWhereYouLive

Visit ThelsoldiCollection.com or call 908-787-5990



110 Wychwood Rd, Westfield
Offered at \$1,849,900



225 Golf Edge, Westfield
Offered at \$1,799,000



1235 Cooper Rd, Scotch Plains
Offered at \$1,749,900



512 Bradford Ave, Westfield
Offered at \$1,625,000



35 Plymouth Rd, Westfield
Offered at \$1,600,000



1231 Cooper Rd, Scotch Plains
Offered at \$1,450,000



12 Manchester Dr, Westfield
Offered at \$1,599,000



281 Hartshorn Dr, Millburn
Offered at \$1,585,000



233 Connecticut St, Westfield
Offered at \$899,900



630 Clark Street, Westfield
Offered at \$1,485,000



1741 Cooper Rd, Scotch Plains
Offered at \$1,379,000



115 Ayliffe Ave, Westfield
Offered at \$1,095,000



917 Tice Place, Westfield
Offered at \$895,000



24 Tanglewood Ln, Mountainside
Offered at \$795,000



111 Prospect St, Unit 2A, Westfield
Offered at \$749,000



109 Palsted Ave, Unit 1, Westfield
Offered at \$599,900

Frank D. Isoldi

Broker / Sales Associate

Coldwell Banker Residential Brokerage

Cell: 908-787-5990

For more follow on Instagram @frankdisoldi | twitter @homeswestfield



RESIDENTIAL BROKERAGE



209 Central Avenue, Westfield
Office: 908-233-5555 x202